

EXISTING REINFORCEMENT BARS	A (min.)	B (min.)	C (min.)
No. 5 (No. 16)	4'-6" (1.4 m)	18 (450)	16 (400)
No. 6 (No. 19)	5'-0" (1.5 m)	21 (525)	19 (475)
No. 7 (No. 22)	5'-6" (1.7 m)	24 (600)	22 (550)
Fabric	5'-0" (1.5 m)	21 (525)	18 (450)

GENERAL NOTES

When patching two adjacent lanes in one operation, the longitudinal joint shall be a longitudinal sawed joint as detailed on Standard 420001; however, the groove may be either preformed or sawed.

All dimensions are in inches (millimeters) unless otherwise shown.

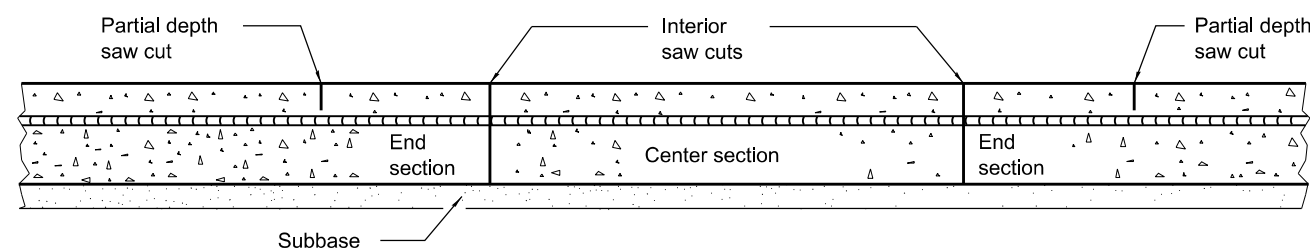

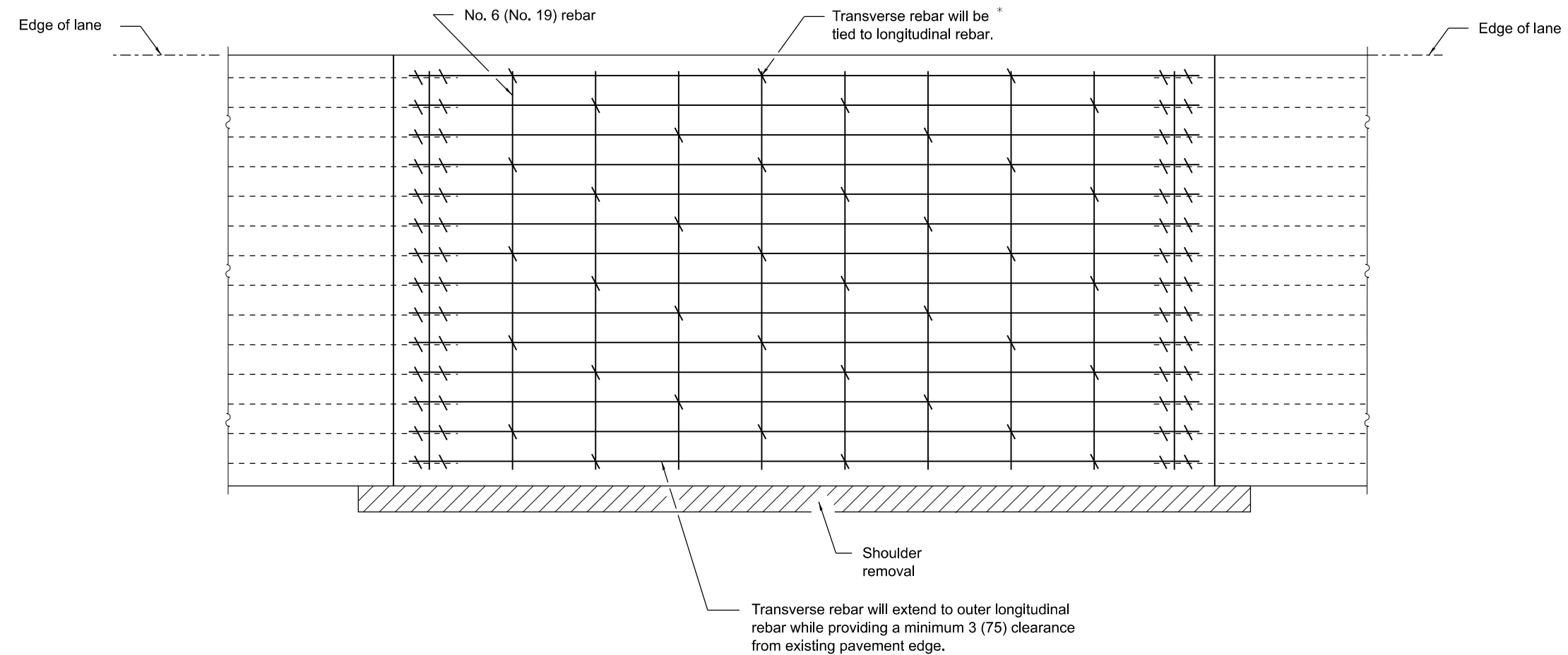

PAVEMENT REINFORCEMENT DETAIL

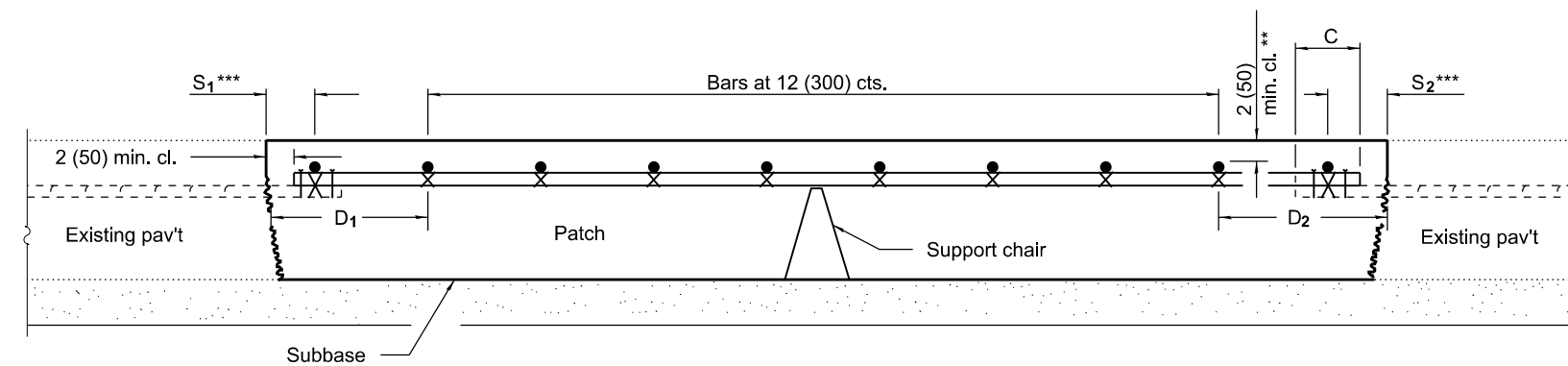

PATCHING DETAIL

- * Every 3rd intersection must be tied.
- ** When the minimum clearance cannot be obtained with the transverse bar on top then the transverse rebar shall be tied to the bottom of the longitudinal rebar.
- *** Variable: Where S_1 and S_2 are $2\frac{1}{2}$ (65) min. and 12 (300) max. $D_1 = 2(S_1)$ and $D_2 = 2(S_2)$.