

\* For precast reinforced concrete sections, this dimension may vary from the dimension given to plus 6 (150).

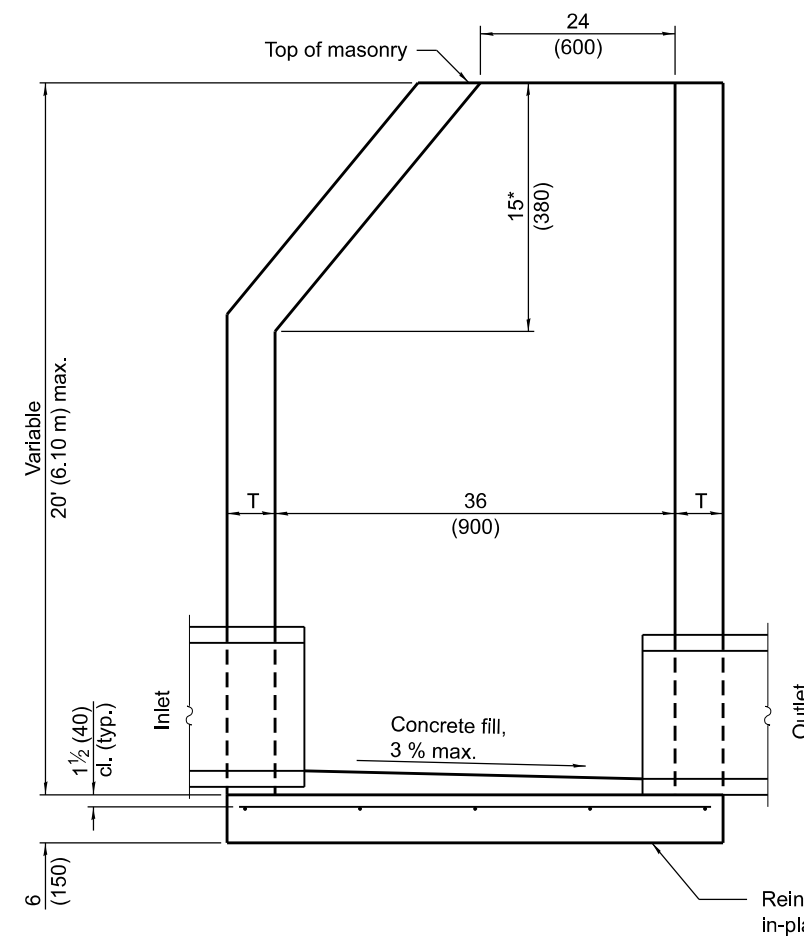

ELEVATION - ECCENTRIC

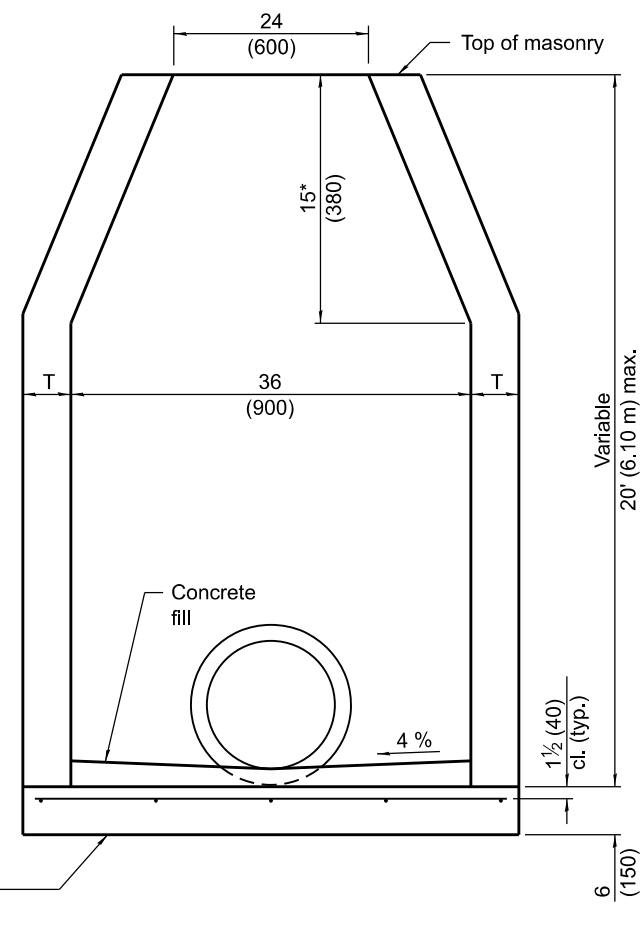

ELEVATION - CONCENTRIC

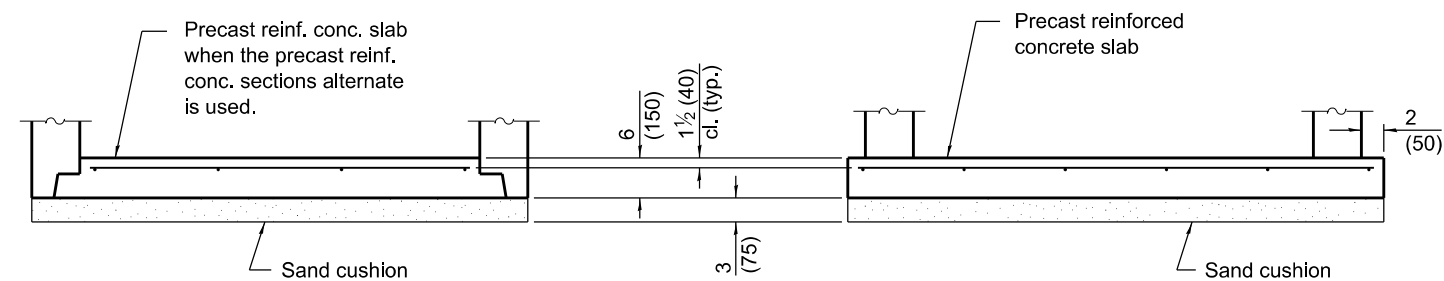

ALTERNATE BOTTOM SLAB

ALTERNATE MATERIALS FOR WALLS	T (min.)
Concrete Masonry Unit	5 (125)
Brick Masonry	8 (200)
Precast Reinforced Concrete Section	3 (75)
Cast-in-Place Concrete	6 (150)

GENERAL NOTES

Bottom slabs shall be reinforced with a minimum of 0.20 sq. in./ft. (420 sq. mm/m) in both directions with a maximum spacing of 12 (300).

Bottom slabs may be connected to the riser as determined by the fabricator; however, only a single row of reinforcement around the perimeter may be utilized.

See Standard 602601 for optional Precast Reinforced Concrete Flat Slab Top.

All dimensions are in inches (millimeters) unless otherwise shown.

DATE	REVISIONS
1-1-11	Detailed rein. in slabs. Added max. limit to height. Revised general notes.
1-1-09	Switched units to English (metric).

INLET - TYPE B

STANDARD 602306-03



Illinois Department of Transportation

APPROVED January 1, 2011

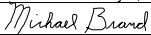
  
ENGINEER OF POLICY AND PROCEDURES

APPROVED January 1, 2011

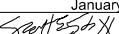
  
ENGINEER OF DESIGN AND ENVIRONMENT

ISSUED 1-1-97