

FENCE USING METAL POSTS

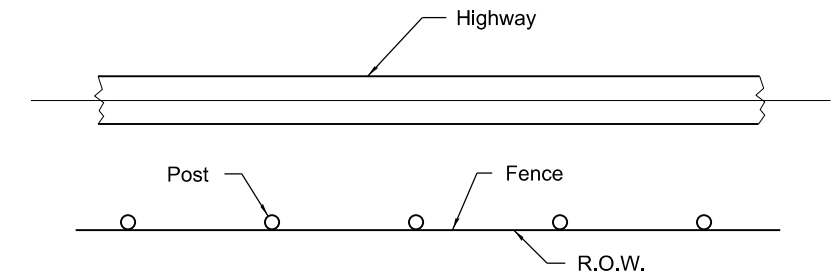

PLAN

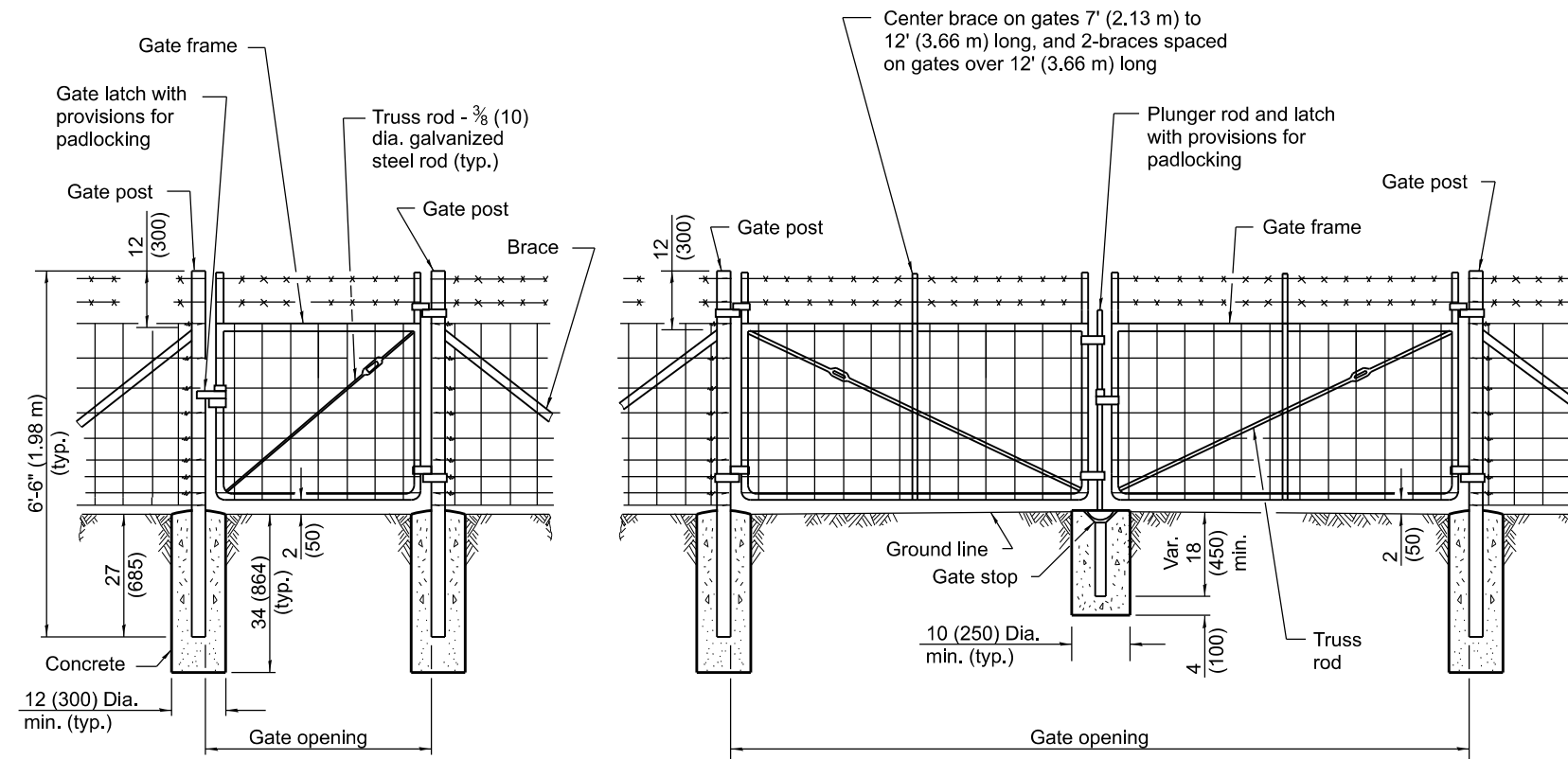

SINGLE GATE

DOUBLE GATE

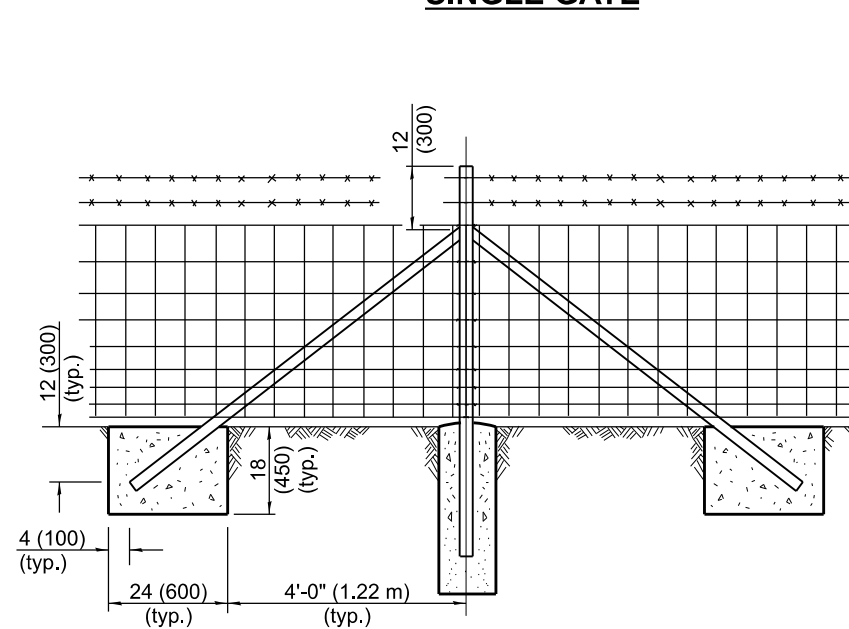

PULL POST

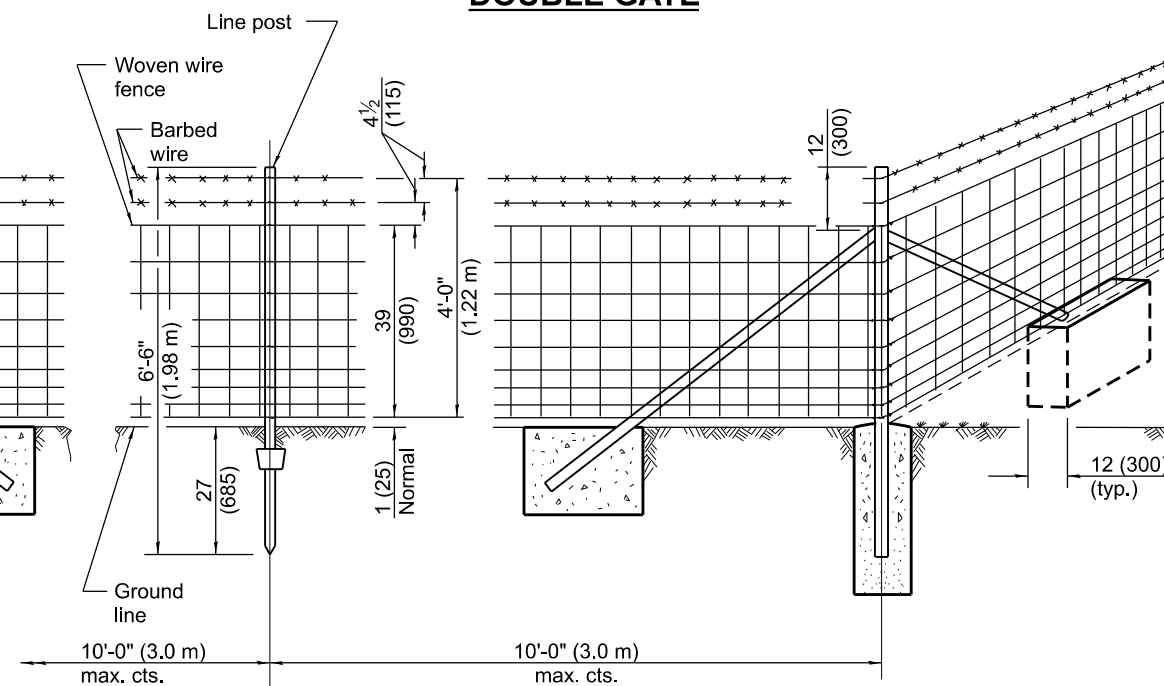

LINE POST

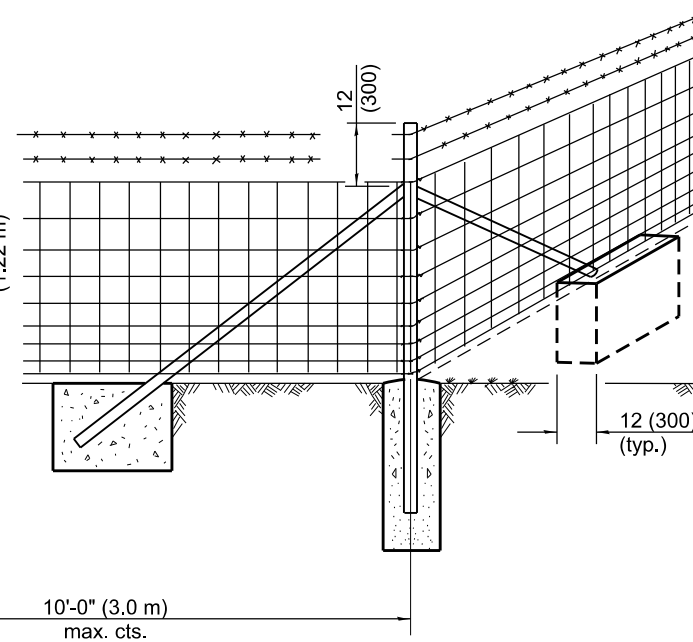

CORNER OR END POST

NOTES

Barbed wires shall be tied to each post. Top and bottom wires of woven fence shall be tied to each post. Tie every other wire between, alternating on successive posts.

Barbed wires and line wires of woven fence shall be fastened to the corner, end, pull, and gate posts by wrapping the wires around the post and tying back on itself with not less than 3 twists tightly wrapped.

GENERAL NOTES

Pull posts shall be placed at the locations determined by the Engineer. They shall be placed at 660' (200 m) intervals between posts to which the ends of the fabric and barbed wires are fastened or midway between such posts when the distance is less than 1320' (400 m) and greater than 660' (200 m).

Bracing for gate posts shall be the same type used for end posts.

The clearance between the bottom fence wire and the ground may be up to 3 (75) for a maximum distance of 8' (2.4 m) when uneven ground is encountered.

All dimensions are in inches (millimeters) unless otherwise shown.

DATE	REVISIONS
1-1-09	Switched units to English (metric).
1-1-02	Corrected dimensions on sheet 3 and 4.

WOVEN WIRE FENCE

(Sheet 1 of 4)

STANDARD 665001-02

FENCE USING WOOD POSTS

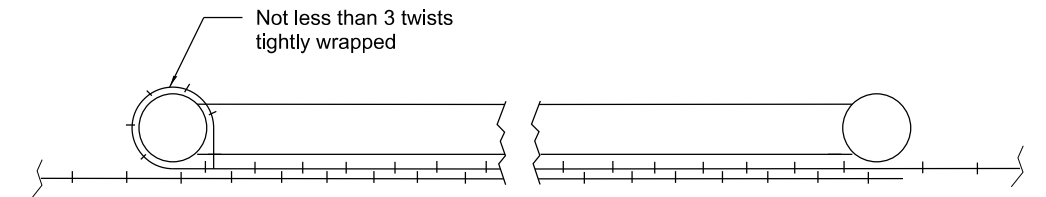
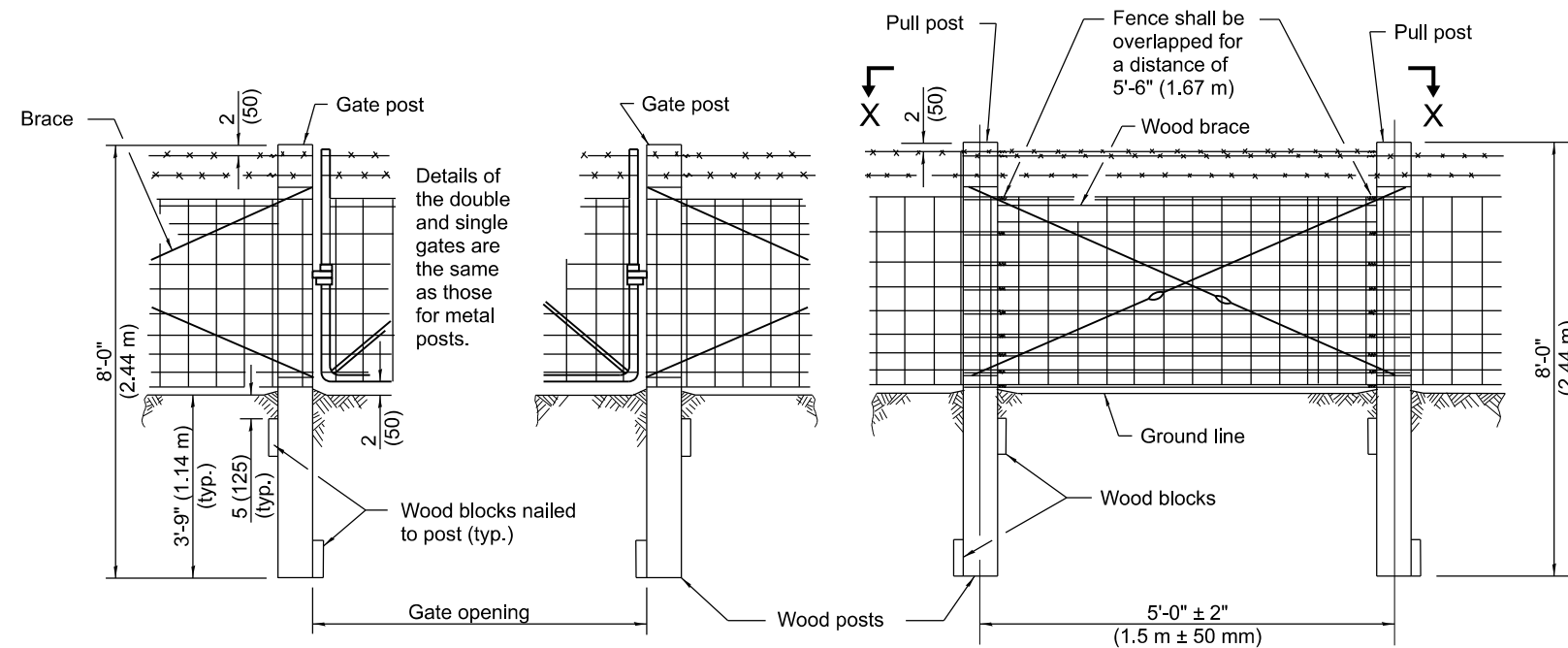

SECTION X-X

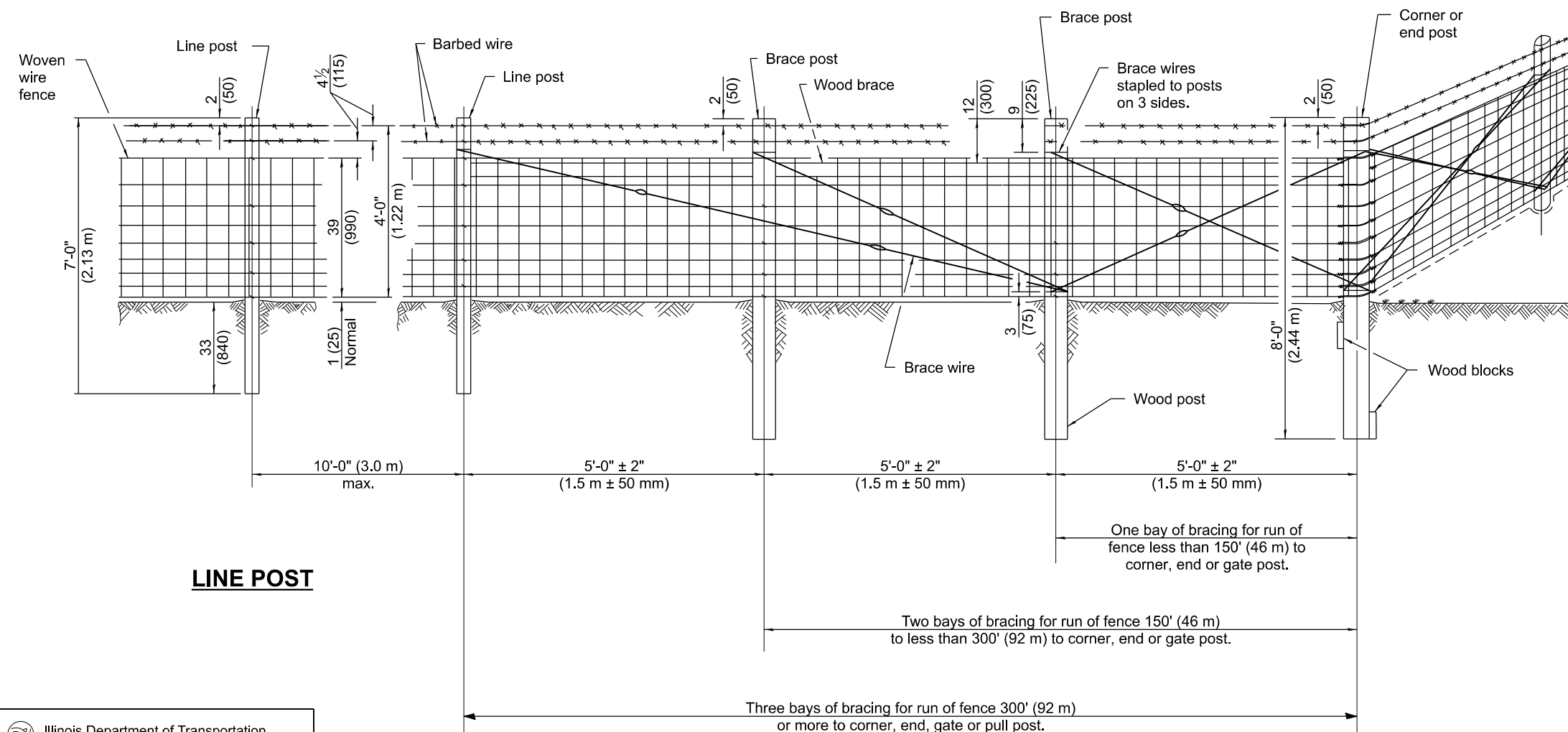

NOTES

Barbed wires shall be stapled to each post. Top and bottom wire of woven fence shall be stapled to each post. Staple every other wire between, alternating on successive posts.

Metal line posts may be used in lieu of wood line posts.

WOVEN WIRE FENCE

(Sheet 2 of 4)

STANDARD 665001-02

CORNER OR END POST

METAL ITEMS

GATE FRAMES		CORNER, END or PULL POSTS		LINE POSTS		BRACES	
Section	lbs./ft. (kg/m)	Section	lbs./ft. kg/m	Section	lbs./ft. (kg/m)	Section	lbs./ft. (kg/m)
Type A: Pipe 1.66 (42.2) O.D. Type B: Pipe 1.66 (42.2) O.D. Type C: Pipe 1.66 (42.2) O.D.	2.27 (3.38) 1.83 (2.72) 1.82 (2.71)	Type A: Pipe 2.375 (60.3) O.D. Type B: Pipe 2.375 (60.3) O.D. Type C: Pipe 2.375 (60.3) O.D. Tubing 2.5 (63.5) Sq. Angle 2½x2½x¼ (64x64x6.4)	3.65 (5.43) 3.11 (4.63) 3.09 (4.60) 4.32 (6.43) 4.1 (6.10)	Type A: Pipe 1.315 (33.4) O.D. Type B: Pipe 1.315 (33.4) O.D. Type C: Pipe 1.315 (33.4) O.D. Tubing 1 (25.4) Sq. L, C, T, U, Y or other approved structural shapes	1.68 (2.50) 1.34 (1.99) 1.33 (1.98) 1.41 (2.10) 1.33 (1.98) min.	Type A: Pipe 1.66 (42.2) O.D. Type B: Pipe 1.66 (42.2) O.D. Type C: Pipe 1.66 (42.2) O.D. Angle 2½x2½x¼ (64x64x6.4) or other approved structural shapes	2.27 (3.38) 1.83 (2.72) 1.82 (2.71) 3.19 (4.75) 3.1 (4.61) min.

METAL ITEMS

GATE POSTS					
Single gate up to 4 ft. (1.22 m) Double gate up to 8 ft. (2.44 m)		over 4 ft. to 8 ft. (1.22 m to 2.44 m) over 8 ft. to 16 ft. (2.44 m to 4.88 m)		over 8 ft. to 12 ft. (2.44 m to 3.66 m) over 16 ft. to 24 ft. (4.88 m to 7.32 m)	
Section	lbs./ft. (kg/m)	Section	lbs./ft. (kg/m)	Section	lbs./ft. (kg/m)
Type A: Pipe 2.375 (60.3) O.D. Type B: Pipe 2.375 (60.3) O.D. Type C: Pipe 2.375 (60.3) O.D. Tubing 2.5 (63.5) Sq. Angle 2½x2½x¼ (64x64x6.4) H, I, U, structural shapes	3.65 (5.43) 3.11 (4.63) 3.09 (4.60) 4.32 (6.43) 4.1 (6.10) 4.1 (6.10) min.	2.875 (73.0) O.D. 2.875 (73.0) O.D. 2.875 (73.0) O.D. 3 (76.2) Sq. 3x3x5⁄16 (76x76x7.9)	5.79 (8.62) 4.64 (6.91) 3.78 (5.63) 5.78 (8.60) 6.1 (9.08) 6.1 (9.08) min.	3.500 (88.9) O.D. 3 (76.2) Sq. 3½x3½x3⁄8 (76x76x9.5)	7.58 (11.28) 8.80 (31.10) 8.5 (10.70) 8.5 (10.70) min.

WOOD ITEMS
(S4S or Rough Sawn)

GATE, CORNER, END or PULL POSTS	BRACES and LINE POSTS	BLOCKS
6 to 7 (150 to 175) Top dia. 6x6 (150x150)	4 to 5 (100 to 125) Top dia. 4x4 (100x100)	2x8x18 (50x200x450)



Illinois Department of Transportation

APPROVED January 1, 2009

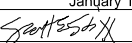

ENGINEER OF POLICY AND PROCEDURES

APPROVED January 1, 2009

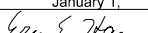

ENGINEER OF DESIGN AND ENVIRONMENT

ISSUED 1-1-97

WOVEN WIRE FENCE

(Sheet 3 of 4)

STANDARD 665001-02

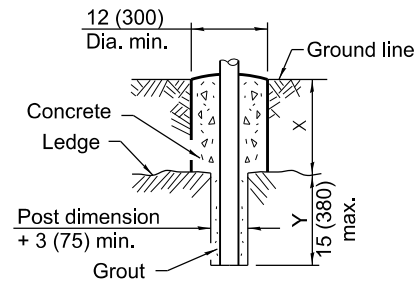

METAL POST

NOTE

X + Y shall not exceed 27 (685), 33 (840), or 3'-9" (1.14 m) as applicable. When X is 0 to 12 (300), 18 (450), or 30 (760), Y = 15 (380), and the post shall be shortened as required. When X exceeds 12 (300), 18 (450), or 30 (760), Y shall be decreased correspondingly.

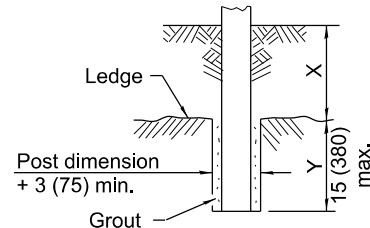

WOOD POST

FOOTING FOR POSTS WHEN ROCK LEDGE IS ENCOUNTERED

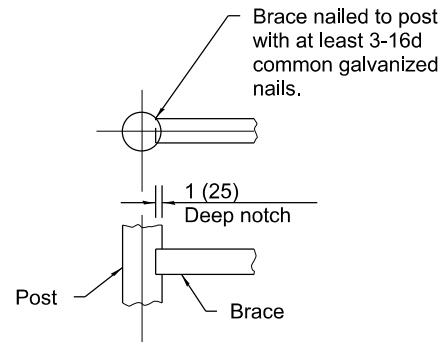
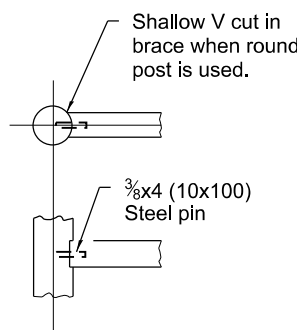

ALTERNATE DETAILS FOR FASTENING WOOD BRACE TO WOOD POST

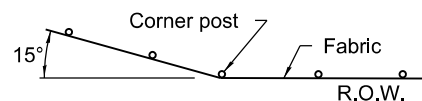

NOTE

Where fence line has a change in direction of 15° or more, a corner post with bracing as required shall be placed as shown above. Where angle is less than 15° and existing conditions require a corner post, they shall be placed as directed by the Engineer.

INSTALLATION AT CORNERS

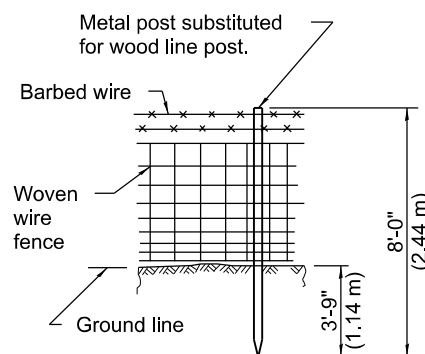

PROTECTIVE ELECTRICAL GROUNDING FOR WOOD POST FENCE INSTALLATION

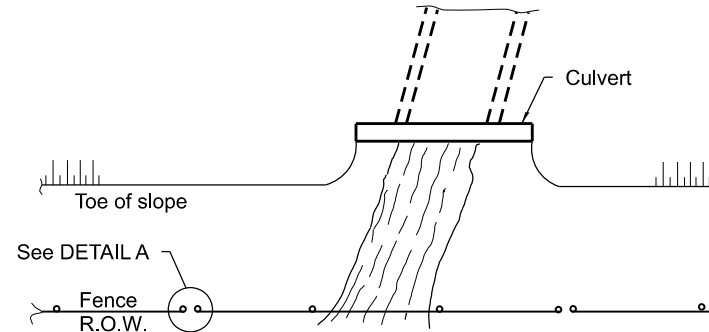

PLAN AT STREAM CROSSING

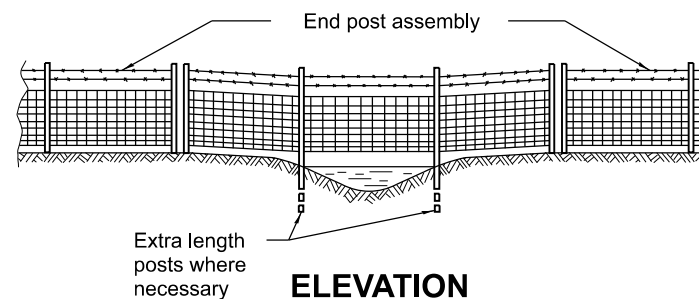

NOTE

The woven wire fabric shall be replaced by barbed wire strands at 12 (300) maximum centers between the double posts shown on DETAIL A when shown on the plans.

INSTALLATION OVER STREAM

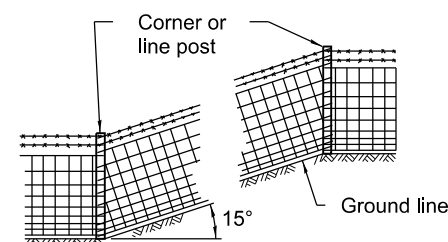

NOTE

Where grade line has a change in slope of 15° or more, a corner post with bracing as required shall be placed as shown above. Where angle is less than 15° line posts may be used.

When the tension of the fence tends to pull the posts from the ground, the line posts shall be anchored with the applicable concrete or wood anchorage specified for corner posts.

INSTALLATION ON SLOPES

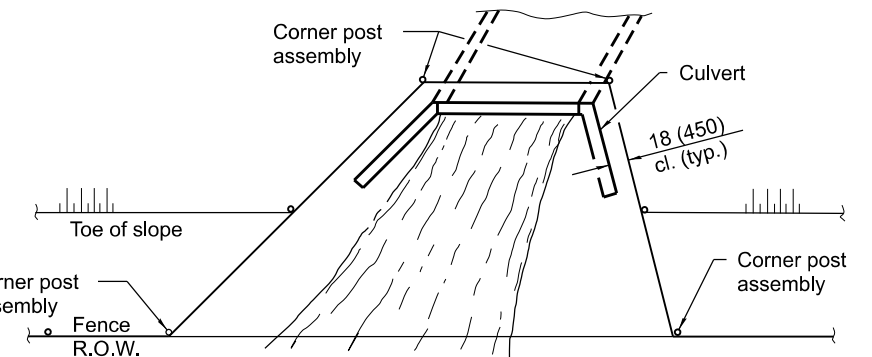

PLAN AT HEADWALL

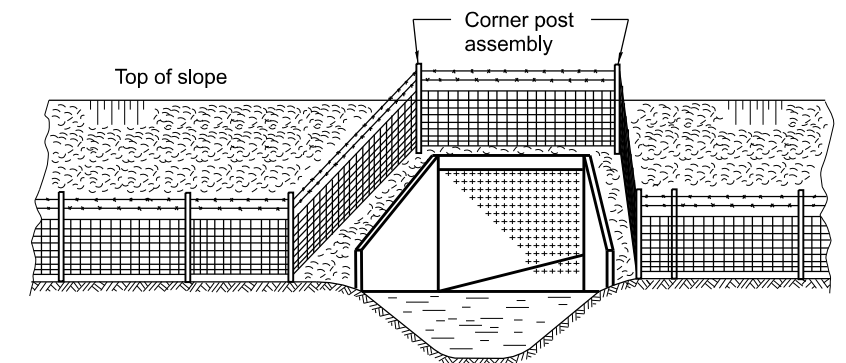

NOTE

When the width of the culvert makes it necessary to anchor a post to the top of the culvert, a cast iron shoe or other device approved by the Engineer shall be used.

INSTALLATION AROUND HEADWALL

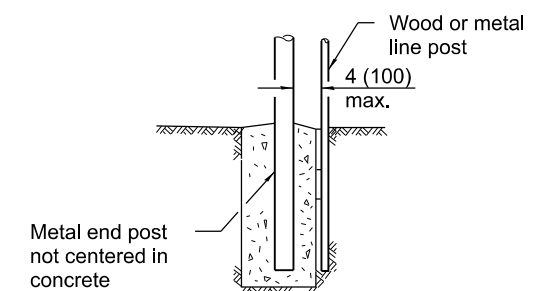

DETAIL A

WOVEN WIRE FENCE

(Sheet 4 of 4)

STANDARD 665001-02

Illinois Department of Transportation

APPROVED January 1, 2009

ENGINEER OF POLICY AND PROCEDURES

APPROVED January 1, 2009

ENGINEER OF DESIGN AND ENVIRONMENT

ISSUED 1-1-97