

① Omit whenever duplicated by road work traffic control.

GENERAL NOTES

This Standard is used where, at any time, pedestrian traffic must be rerouted due to work being performed.

This Standard must be used in conjunction with other Traffic Control & Protection Standards when roadway traffic is affected.

Temporary facilities shall be detectable and accessible.

The temporary pedestrian facilities shall be provided on the same side of the closed facilities whenever possible.

The SIDEWALK CLOSED / USE OTHER SIDE sign shall be placed at the nearest crosswalk or intersection to each end of the closure. Where the closure occurs at a corner, the signs shall be erected on the corners across the street from the closure. The SIDEWALK CLOSED signs shall be used at the ends of the actual closures.

Type III barricades and R11-2-4830 signs shall be positioned as shown in "ROAD CLOSED TO ALL TRAFFIC" detail on Standard 701901.

All dimensions are in inches (millimeters) unless otherwise shown.

SYMBOLS

- Work area
- Sign on portable or permanent support
- Barricade or drum
- Cone, drum or barricade
- Type III barricade
- Detectable pedestrian channelizing barricade

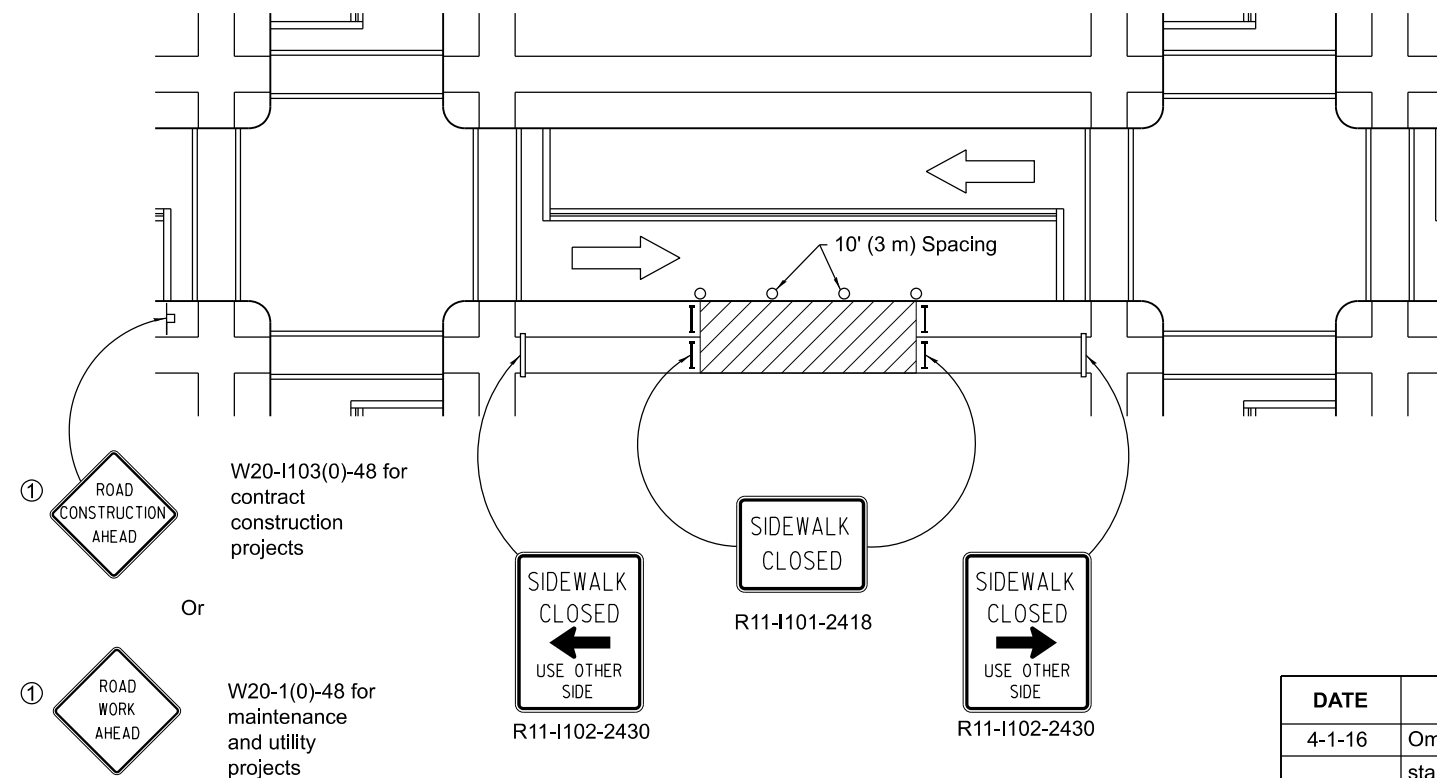

SIDEWALK CLOSURE

DATE	REVISIONS
4-1-16	Omitted orange safety fence from standard as this is covered in the standard spec.
1-1-12	Added SIDEWALK DIVERSION.
	Modified appearance of plan views.
	Renamed Standard.

SIDEWALK, CORNER OR CROSSWALK CLOSURE

(Sheet 1 of 2)

STANDARD 701801-06

Illinois Department of Transportation	
APPROVED January 1, 2016	ISSUED 1-1-97
ENGINEER OF SAFETY ENGINEERING	
APPROVED January 1, 2016	
ENGINEER OF DESIGN AND ENVIRONMENT	

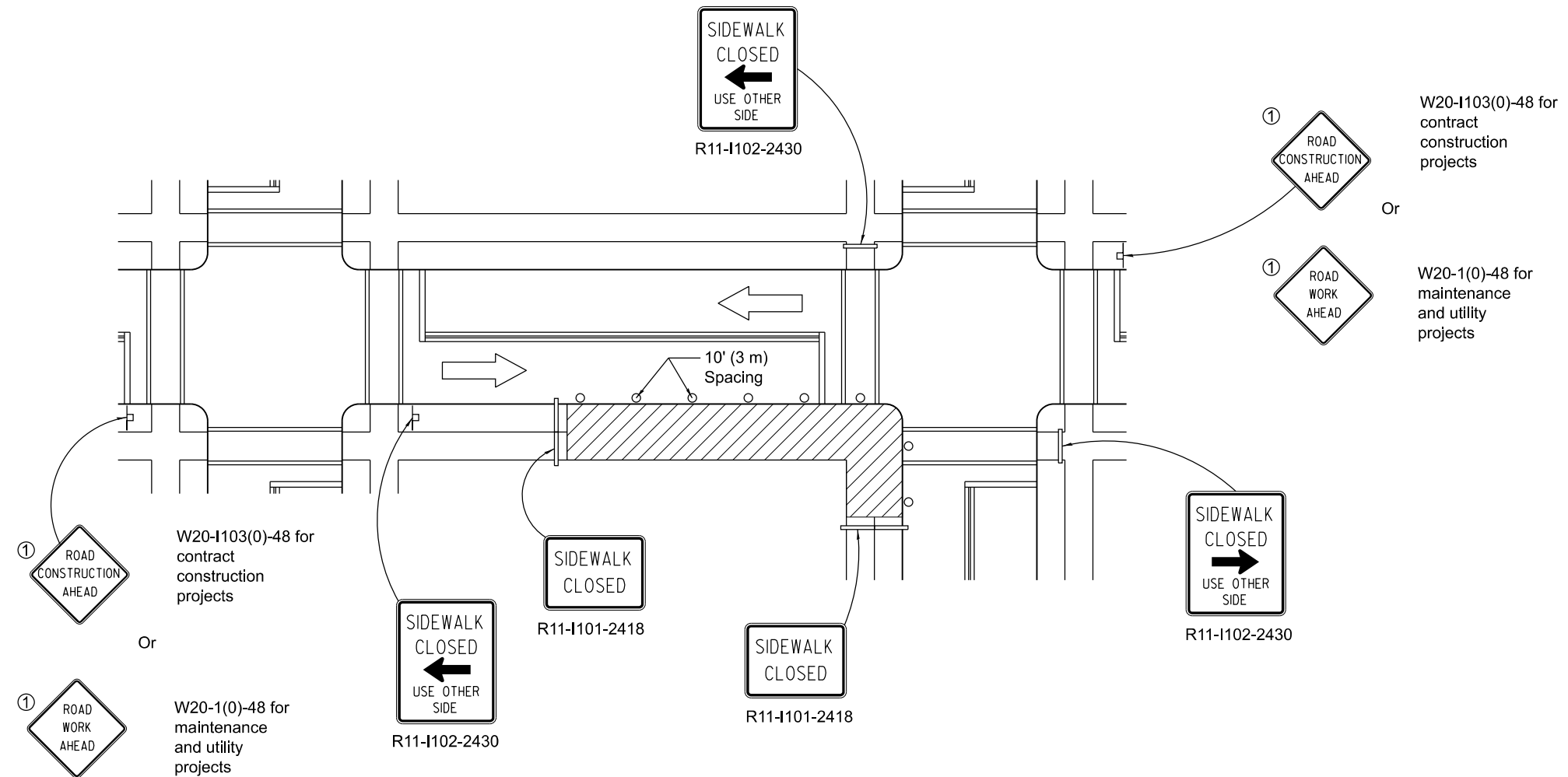

CORNER CLOSURE

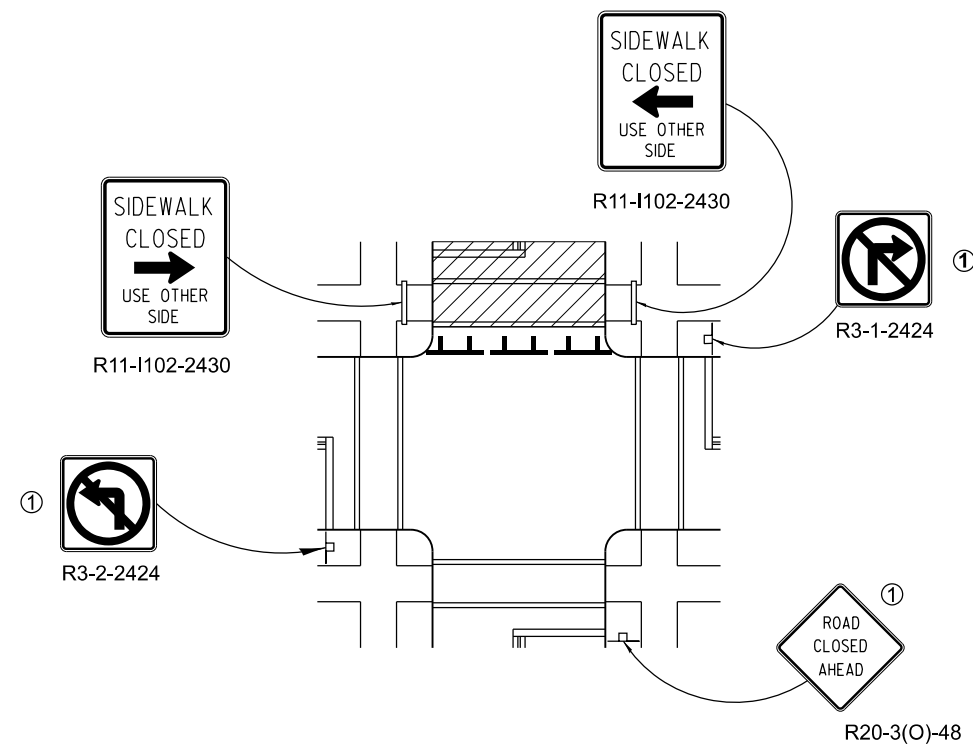

CROSSWALK CLOSURE